

Shanghai Liangxin Electrical Co., Ltd.

Product Specification of NDB6Z-125

Products Name: Moulded Case Circuit DC Breaker

Products model: NDB6Z-125

Date: 20210201

Prepare	Feng Dai	Date	2021-02-01
Review	ZhiQiangHuo	Date	2021-02-01
Approve	YangZhang	Date	2021-02-01

Revision record					
Version	Revise contents	Revision date	Reviser	Reviewer	Approver
0	Initial issue	20120807	yang zhang	Huo zhi qiang	Wei Yang
2	Change of address	20160126	Heng Ke	Huo zhi qiang	Wei Yang
3	The new standard	20190906	Heng Ke	Huo zhi qiang	Wei Yang
4	Perfect wiring diagram	20181019	Feng Dai	Huo zhi qiang	Wei Yang
5	Upgrade	20210201	Feng Dai	Huo zhi qiang	Yang Zhang

1、Applicable scope and purpose

- Short -circuit protection
- Over-load protection
- Control
- Isolation
- Dc system protection
- Criterion: GB/T14048.2 、 IEC60947-2

NDB6Z-125 DC breaker is also wildly used in the final distribution of solar, industry automation, energy, telecom and infrastructure sectors.

2、Picture: (The picture is for reference only; the specific kind prevail)



1P product



2P product



3P product



4P product

3、Model and implication:

ND	B	6	Z	—	125	C	63	/	1
Nader	Breaker	Design code	Current type Z for DC		Frame Rating 63A	Tripping characteristic C	Rated current (A) 63,80, 100,125		Poles 1=1P, 2=2P, 3=3P, 4=4P

4、Main technical specification

- electric parameter
 - Rated working voltage :DC60/80/125/250/300V(1P), DC400/500/600V(2P), DC750/1000V(3P), DC1000/1200V(4P)
 - Rated current: 63A, 80A, 100A, 125A
 - Rated breaking capacity : Rated operating short circuit capacity:Ics=6kA(2P-4P),
6 kA (1P DC 250/300V),7.5kA(1P DC60/80/125V) , (2P DC400V)
 - Rated ultimate breaking capacity: Icu=6kA(2P-4P) , 15kA(1P DC60/80/125V),6kA(1P DC250/300V)
10kA(2P DC400V)

- Impulse voltage endurance : 4kV
- Application category : A
- Isolation function
- Practical breaking instructions
- View window within the green identification said contact in the off position
- Mechanical life: 10000 times;
- Wiring: Tunnel type terminal;
- 10 mm² – 50 mm² conducting wire.
- Standards and Certificates
 - GB/T 14048.2、 IEC 60947-2
- Environmental requirements: RoHS
- Wiring Diagram (Only part of the product voltage is shown)

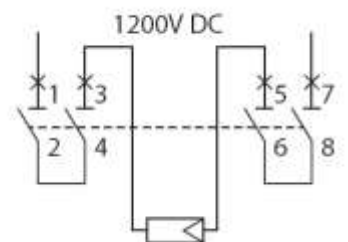
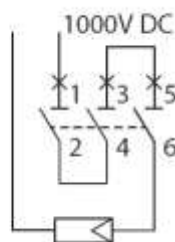
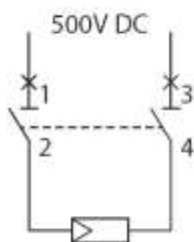
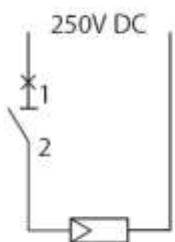
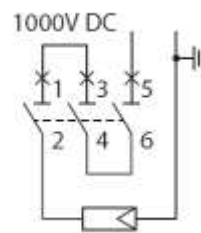
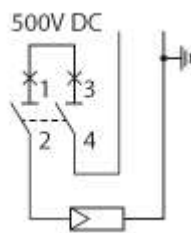
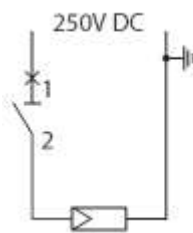

5、Normal working environment

- ambient temperature: $-40^{\circ}\text{C} \sim +70^{\circ}\text{C}$
- Air relative humidity: $\leq 95\%$
- height: $\leq 2000\text{m}$
- pollution degree :3
- service place without significant vibration and impact

6. Tripping characteristic

C type curve

- Protect normal load and distribution wirecable
- rated current: 63A、80A、100A、125A
- tripping characteristic: The instantaneous tripping range $8I_n$ ($1 \pm 20\%$)

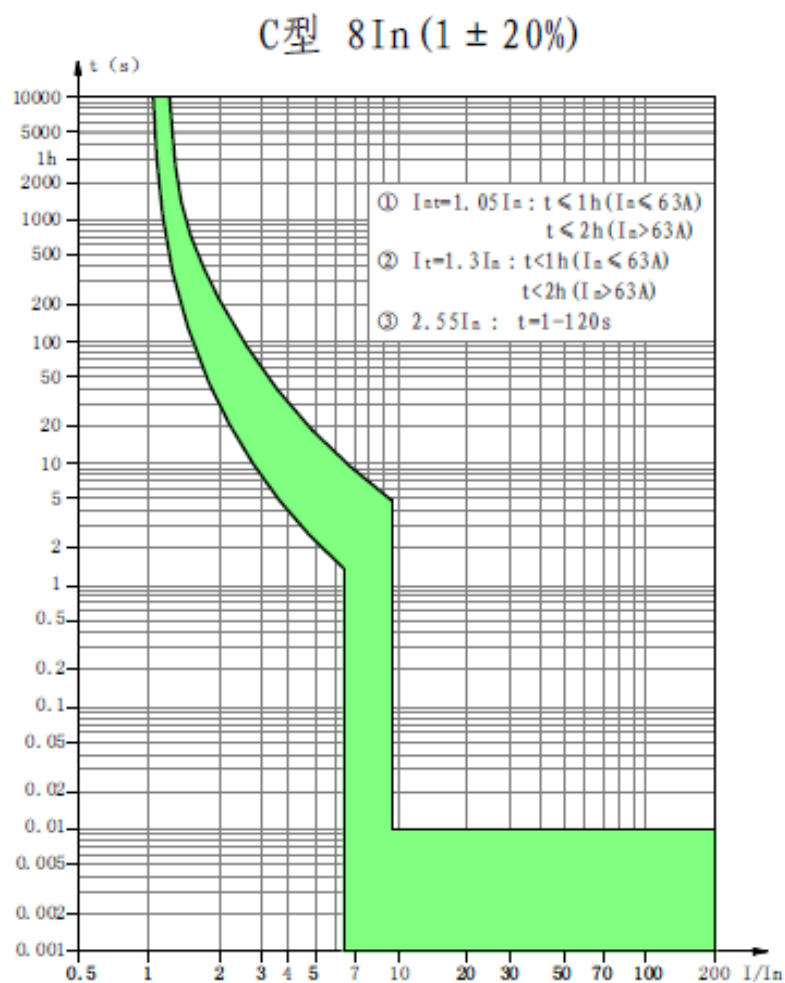

7、Outline dimensions

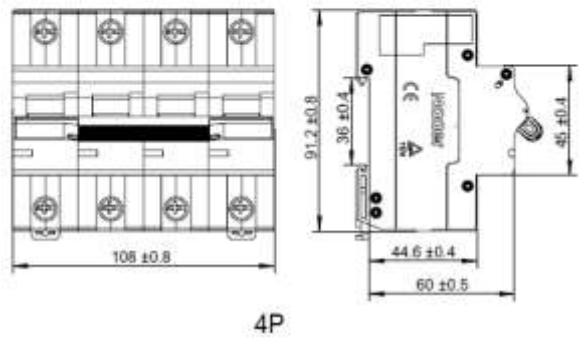
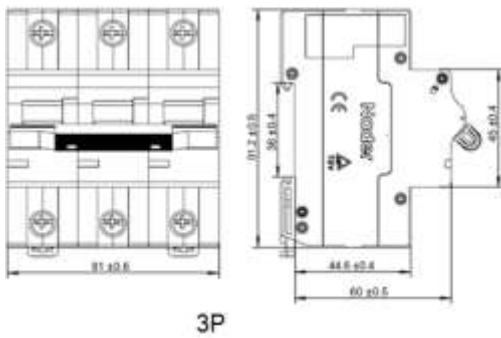
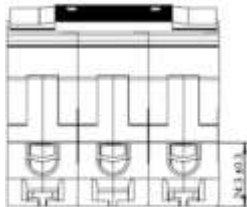
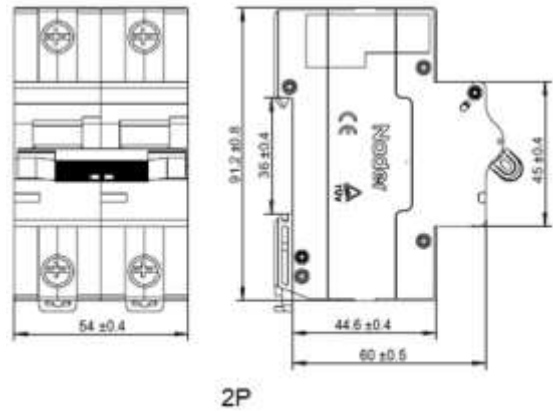
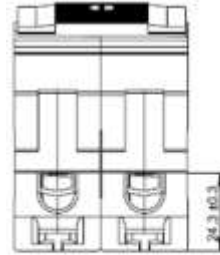
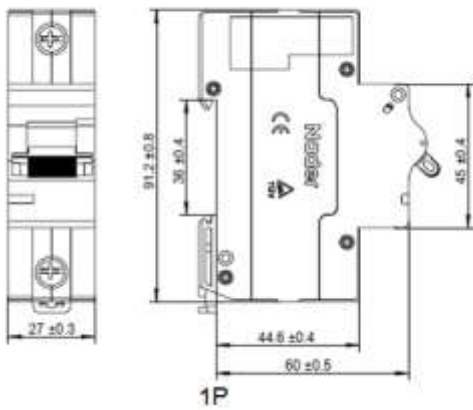
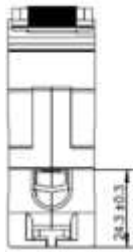

8、Mounting

Modular construction, can be installed in TH35mm x 7.5 standard guide rail

9、Packing storage

quantity (1P product: 9PCS/box, 2P product: 4PCS/box, 3P product: 3PCS/box, 4P product: 2PCS/box), Packing boxes of products should be stored in the air circulation and relative humidity is not more than 80% and the temperature is not higher than + 80 °C, Not less than - 40 °C in the air around without acid, alkali or other corrosive gases stored in the warehouse. In the above conditions, the storage period since the production date not more than three years.

10、Accessories list and mounting

N/A

11、 Notice

- The manufacturer is irresponsible for quality problems caused by disassembling products privately;
- Do not touch the Non-insulated and exposed parts during the electrified working condition;
- Don't test characteristics of the breaker optionally, the manufacturer is irresponsible for such quality problems;
- Keep wiring correct to prevent malfunction or damage of wiring terminals.